

P/N LEGEND

C6350	WV-XP	FV0
①	②	③
① Series No.	② Connector type: WV=Vertical	③ No. of circuits
④ FV0=F type, Nylon 66,UL94V-0, White		

SPECIFICATIONS

Current Rating: 15A AC,DC  
 Voltage Rating: 600V AC,DC  
 Temperature Range: -25°C ~ +85°C  
 Contact Resistance: 3.5mΩ Max  
 Insulation Resistance: 1000MΩ Min  
 Withstanding Voltage: 2900V AC/minute  
 Pin Material: Brass/Tin-plated  
 Material: Nylon 66,UL94V-0  
 Color: White

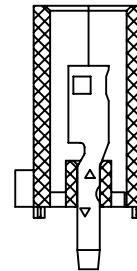
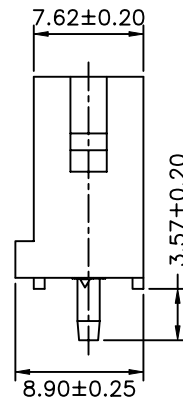
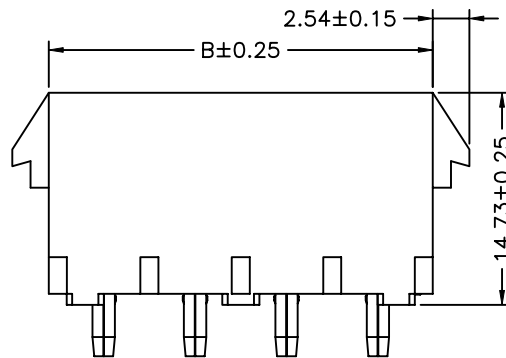

Ordering Information & Dimensions

PART NO.	Dimensions	
	A	B
C6350WV-02PFV0	6.35	13.97
C6350WV-03PFV0	12.70	20.32
C6350WV-04PFV0	19.05	26.67
C6350WV-05PFV0	25.40	33.02
C6350WV-06PFV0	31.75	39.37
C6350WV-08PFV0	44.45	52.07

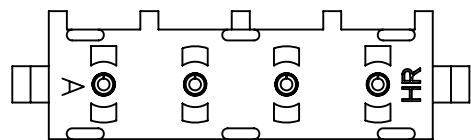

							燦達電子工業股份有限公司 JOINT TECH ELECTRONIC IND. CO., LTD.			
		UNIT	SCALE	SHEET	TITLE:					
		mm	1 : 1	1 of 1	6.35mm PITCH 180° SINGLE ROW WAFER, FEMALE TYPE					
		DRAWN BY	APPROVED BY							
		李勤	董正一		DRAW NO. : C6350WV-XPV0					
		2006.02.25	2006.02.25							
		GENERAL TOLERANCE			REV. A2					
A2	EN1703020002	2017.03.13	賴永強	X. X±0.25					ANGLE±	
A1	REVISE	2007.09.14	歐陽小強	X. XX±0.15						
A0	NEW RELEASE	2006.02.25	李勤	X. XXX±0.05						
REV.	DESCRIPTION	DATE	NAME							