

P/N LEGEND

C6350	HF	XP	N	0	W	NP	N	00	G
①	②	③	④	⑤	⑥	⑦	⑧	⑨	⑩

① Series No.  
 ② Connector type: HF=Receptacle  
 ③ No. of circuits  
 ④ N=Halogen Free  
 ⑤ Material: 0=Nylon66 UL94-V0  
 ⑥ Color: W=White  
 ⑦ Plating code for contacts: NP=Non-plating  
 ⑧ Plating code: N=Non-plating  
 ⑨ Option code: 00=Standard  
 ⑩ Packing code: G=Bag

SPECIFICATIONS

Current Rating: 15A AC,DC  
 Voltage Rating: 600V AC,DC  
 Temperature Range: -25°C ~ +85°C  
 Contact Resistance: 3.5mΩ Max  
 Insulation Resistance: 1000MΩ Min  
 Withstanding Voltage: 2900V AC/minute

Circuit No.	Dimensions	
	A	B
02P	6.35	13.97
03P	12.70	20.32
04P	19.05	26.67
05P	25.40	33.02
06P	31.75	39.37
08P	44.45	52.07

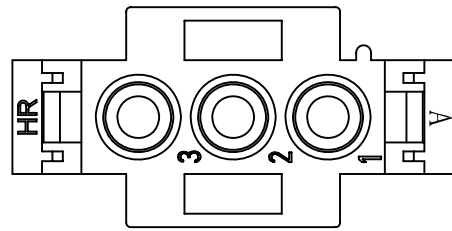
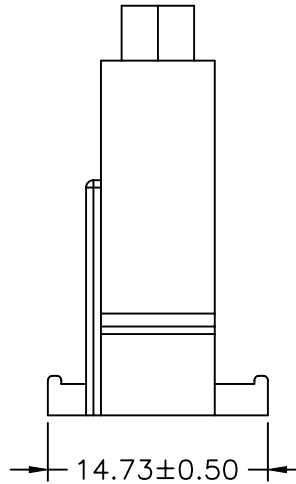
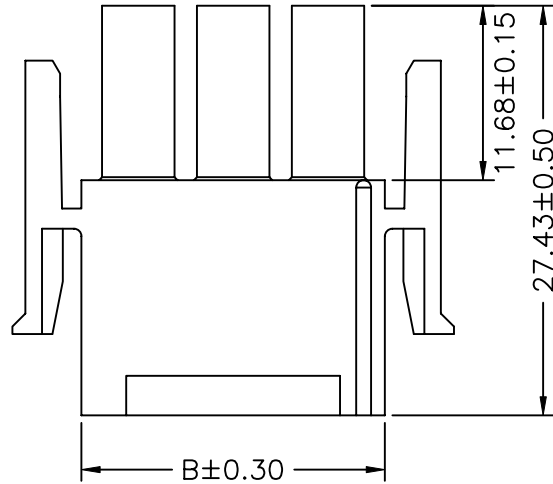

03-08P

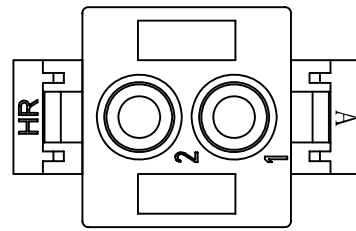

02P

REV.	DESCRIPTION	DATE	NAME
A1	EN1507EN1703020002	2017.03.13	賴永強
A0	NEW RELEASE	2016.01.11	郭木思



燦達電子工業股份有限公司  
 JOINT TECH ELECTRONIC IND. CO., LTD.

UNIT	SCALE	SHEET
mm	1 : 1	1 of 1
DRAWN BY	APPROVED BY	
郭木思	陳彥兆	
2016.01.11	2016.01.11	

GENERAL TOLERANCE	
X.X±0.25	ANGLE±
X.XX±0.15	
X.XXX±0.05	

TITLE:	
6.35mm PITCH SINGLE ROW HOUSING- RECEPTACLE	
DRAW NO. :	REV.
C6350HF-XPXXXXXXX	A1

1|

2|

3|

4|

1|

2|

3|

4|